

CASH FARES / Tarifas en efectivo

Exact fare, please / Favor de pagar la cantidad exacta	
Day Pass (Regional) / Pase diario (Regional)	\$5.00
One-Way Fare / Tarifa de una dirección	\$2.25
Senior (60+)/Disabled/Medicare Mayores de 60 años/Discapacitados/Medicare	\$1.10*
Children 5 & under / Niños de 5 años o menores	FREE / GRATIS*
MONTHLY PASSES / Pases mensual Effective July 2009	
Adult / Adulto	\$72.00
Senior (60+)/Disabled/Medicare Mayores de 60 años/Discapacitados/Medicare	\$18.00*
Youths (18 and under) Jóvenes (18 años o menores)	\$36.00*

DAY PASS (REGIONAL) / Pase diario (Regional)

Valid for unlimited travel for one person on Trolley, most MTS buses, NCTD Breeze and SPRINTER. Valid for a discount on COASTER fares; not valid on Premium Express, Rural, or special service buses, or ADA paratransit.

Válidos para viajes ilimitados de una sola persona para: el Trolley, la mayoría de los autobuses de MTS, y los servicios del NCTD de BREEZE y SPRINTER. Válidos para acceder a descuentos en el COASTER, pero no para las rutas Premium Express ni rurales, los servicios especiales ni los servicios para discapacitados de ADA.

* I.D. required for discount fare or pass.
* Se requiere identificación para tarifas o pases de descuento.

DIRECTORY / Directorio

Regional Transit Information Información de transporte público regional	511 or/ó (619) 233-3004
TTY/TDD (teletype for hearing impaired) Teletipo para sordos	(619) 234-5005 or/ó (888) 722-4889
InfoExpress (24-hour info via Touch-Tone phone) Información las 24 horas (via teléfono de teclas)	(619) 685-4900
Customer Service / Suggestions Servicio al cliente / Sugerencias	(619) 557-4555
SafeWatch	(619) 557-4500
The Transit Store / Lost & Found The Transit Store / Objetos extraviados	(619) 234-1060
Articles found on the bus are turned in at The Transit Store Artículos encontrados en los autobuses son entregados a The Transit Store	1st & Broadway Downtown San Diego M-F 9am-5pm
For MTS online trip planning Planificación de viajes por Internet	www.sdmts.com

For more information on riding MTS services, pick up a Rider's Guide on a bus or at the Transit Store, or visit www.sdmts.com.
Para obtener más información sobre el uso de los servicios de MTS, recoga un 'Rider's Guide' en un autobús o en 'The Transit Store,' o visita a www.sdmts.com.

Thank you for riding MTS! ¡Gracias por viajar con MTS!

15

SDSU – Downtown
Limited stops via El Cajon Blvd.

DESTINATIONS

- Campus Plaza
- El Cajon Blvd.
- Hoover High School
- San Diego State University
- The Boulevard Transit Plaza



SDSU
City College



The schedules and other information shown in this timetable are subject to change. MTS does not assume responsibility for errors in timetables nor for any inconvenience caused by delayed buses.
Los horarios y información que se indican en este itinerario están sujetos a cambios. MTS no asume responsabilidad por errores en los itinerarios, ni por ningún perjuicio que se origine por los autobuses demorados.

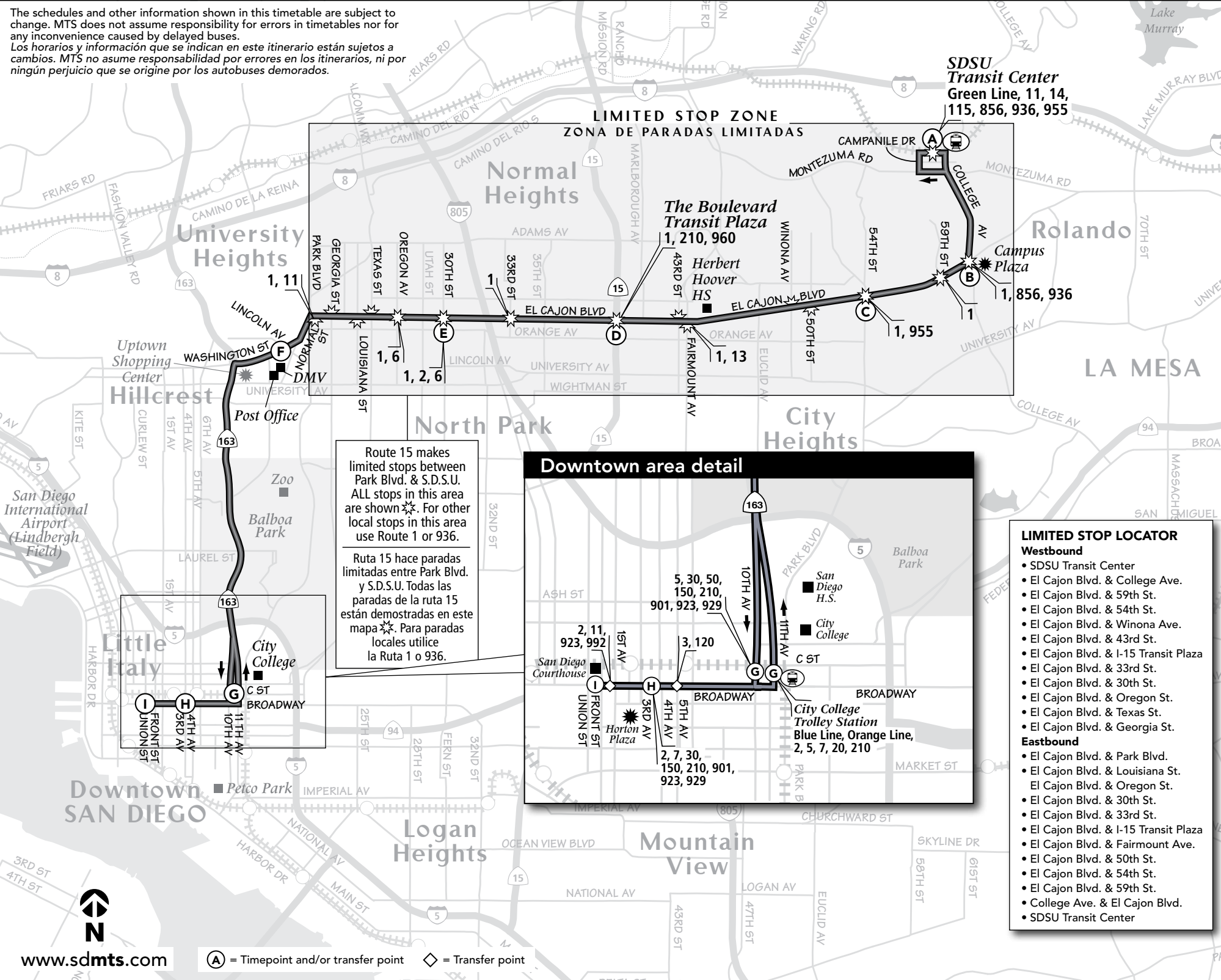

The Transit Store

Your full-service store for

- Tickets and Passes
- Brochures
- Maps and Timetables
- Compass Cards
- Souvenirs
- Transit IDs and more!

102 Broadway (at First Avenue)
Downtown San Diego
Monday - Friday, 9:00 a.m. to 5:00 p.m.

MTS
www.sdmts.com

Route 15 Monday through Friday / lunes a viernes

Downtown → City Heights → SDSU

(I) Broadway & Front St. DEPART	(H) Broadway & 3rd Ave.	(G) City College Trolley	(F) Washington St. & Lincoln Ave.	(E) El Cajon Blvd. & 30th St.	(D) Boulevard Transit Plaza (@ Fwy. 15)	(C) El Cajon Blvd. & 54th St.	(B) College Ave. & El Cajon Blvd.	(A) SDSU Transit Center ARRIVE
4:42a	4:45a	4:49a	4:53a	4:58a	5:03a	5:10a	5:12a	5:19a
5:12	5:15	5:19	5:23	5:28	5:33	5:40	5:42	5:49
5:42	5:45	5:49	5:53	5:58	6:03	6:10	6:12	6:19
5:57	6:00	6:04	6:08	6:13	6:18	6:25	6:27	6:34
6:12	6:15	6:19	6:23	6:28	6:33	6:40	6:42	6:49
6:27	6:30	6:35	6:39	6:45	6:50	6:58	7:01	7:09
6:42	6:45	6:50	6:54	7:00	7:05	7:13	7:16	7:24
6:57	7:00	7:05	7:09	7:15	7:20	7:28	7:31	7:39
7:11	7:15	7:21	7:26	7:32	7:38	7:48	7:51	7:59
7:26	7:30	7:36	7:41	7:47	7:53	8:03	8:06	8:14
7:41	7:45	7:51	7:56	8:02	8:08	8:18	8:21	8:29
7:56	8:00	8:06	8:11	8:17	8:23	8:33	8:36	8:44
8:11	8:15	8:21	8:26	8:32	8:38	8:48	8:51	8:59
8:26	8:30	8:36	8:41	8:47	8:53	9:03	9:06	9:14
AND THEN EVERY 15 MINUTES AT: / Y LUEGO CADA 15 MINUTOS A LA:								
:41	:45	:51	:55	:02	:09	:19	:22	:30
:56	:00	:06	:10	:17	:24	:34	:37	:45
:11	:15	:21	:25	:32	:39	:49	:52	:00
:26	:30	:36	:40	:47	:54	:04	:07	:15
UNTIL: / HASTA:								
3:41p	3:45p	3:51p	3:56p	4:04p	4:11p	4:21p	4:24p	4:33p
3:56	4:00	4:06	4:11	4:19	4:26	4:36	4:39	4:48
4:11	4:15	4:21	4:26	4:34	4:41	4:51	4:54	5:03
4:26	4:30	4:36	4:41	4:49	4:56	5:06	5:09	5:18
4:41	4:45	4:51	4:56	5:04	5:11	5:21	5:24	5:33
4:56	5:00	5:06	5:11	5:19	5:26	5:36	5:39	5:48
5:11	5:15	5:21	5:26	5:34	5:41	5:51	5:54	6:03
5:26	5:30	5:36	5:41	5:49	5:56	6:06	6:09	6:18
5:41	5:45	5:51	5:56	6:04	6:11	6:21	6:24	6:33
5:56	6:00	6:06	6:10	6:18	6:24	6:34	6:36	6:44
6:11	6:15	6:21	6:25	6:33	6:39	6:49	6:51	6:59
6:26	6:30	6:36	6:40	6:48	6:54	7:04	7:06	7:14
6:41	6:45	6:51	6:55	7:03	7:09	7:19	7:21	7:29
6:56	7:00	7:06	7:10	7:18	7:24	7:34	7:36	7:44
7:12	7:15	7:20	7:24	7:31	7:37	7:46	7:48	7:56
7:27	7:30	7:35	7:39	7:46	7:52	8:01	8:03	8:11
7:42	7:45	7:50	7:54	8:01	8:07	8:16	8:18	8:26
8:12	8:15	8:20	8:24	8:31	8:37	8:46	8:48	8:56
8:42	8:45	8:50	8:54	9:01	9:07	9:16	9:18	9:26
9:12	9:15	9:19	9:23	9:29	9:35	9:43	9:45	9:52
9:42	9:45	9:49	9:53	9:59	10:05	10:13	10:15	10:22
10:12	10:15	10:19	10:23	10:29	10:35	10:43	10:45	10:52
10:42	10:45	10:49	10:53	10:59	11:05	11:13	11:15	11:22
11:12	11:15	11:19	11:23	11:29	11:35	11:43	11:45	11:52
11:42	11:45	11:49	11:53	11:59	12:05a	12:13a	12:15a	12:22a
12:12a	12:15a	12:19a	12:23a	12:29a	12:35	12:43	12:45	12:52
LIMITED STOP ZONE / ZONA DE PARADAS LIMITADAS								

SDSU → City Heights → Downtown

(A) SDSU Transit Center DEPART	(B) El Cajon Blvd. & College Ave.	(C) El Cajon Blvd. & 54th St.	(D) Boulevard Transit Plaza (@ Fwy. 15)	(E) El Cajon Blvd. & 30th St.	(F) Washington St. & Lincoln Ave.	(G) 10th Ave. & C St.	(H) Broadway & 4th Ave.	(I) Broadway & Union St. ARRIVE
—	—	—	4:30a	4:34a	4:39a	4:43a	4:46a	4:49a
4:32a	4:35a	4:37a	4:45	4:49	4:54	4:57	5:01	5:04
5:02	5:05	5:07	5:15	5:19	5:24	5:28	5:31	5:34
5:17	5:20	5:22	5:30	5:34	5:39	5:43	5:46	5:49
5:32	5:35	5:37	5:45	5:49	5:54	5:58	6:01	6:04
5:47	5:50	5:52	6:00	6:04	6:09	6:13	6:16	6:19
6:02	6:05	6:07	6:15	6:19	6:24	6:28	6:31	6:34
6:17	6:20	6:23	6:31	6:35	6:40	6:44	6:47	6:50
6:32	6:35	6:38	6:46	6:51	6:56	7:00	7:03	7:06
6:42	6:45	6:48	6:56	7:01	7:06	7:10	7:13	7:16
6:52	6:55	6:58	7:06	7:11	7:16	7:20	7:23	7:26
7:02	7:05	7:08	7:16	7:21	7:26	7:30	7:33	7:36
7:12	7:16	7:19	7:28	7:33	7:38	7:42	7:45	7:48
7:22	7:26	7:29	7:38	7:44	7:49	7:53	7:56	7:59
7:32	7:36	7:39	7:48	7:54	8:01	8:06	8:10	8:14
7:47	7:51	7:54	8:03	8:09	8:16	8:21	8:25	8:29
8:02	8:06	8:09	8:18	8:24	8:31	8:36	8:40	8:44
8:17	8:21	8:24	8:33	8:39	8:46	8:51	8:55	8:59
AND THEN EVERY 15 MINUTES AT: / Y LUEGO CADA 15 MINUTOS A LA:								
:32	:36	:39	:48	:54	:01	:06	:10	:15
:47	:51	:54	:03	:09	:16	:21	:25	:30
:02	:06	:09	:18	:24	:31	:36	:40	:45
:17	:21	:24	:33	:39	:46	:51	:55	:00
UNTIL: / HASTA:								
3:32p	3:36p	3:39p	3:48p	3:54p	4:02p	4:07p	4:11p	4:16p
3:47	3:51	3:54	4:03	4:09	4:17	4:22	4:26	4:31
4:02	4:06	4:09	4:18	4:24	4:32	4:37	4:41	4:46
4:17	4:21	4:24	4:33	4:39	4:47	4:52	4:56	5:01
4:32	4:36	4:39	4:48	4:54	5:02	5:07	5:11	5:16
4:47	4:51	4:54	5:03	5:09	5:17	5:22	5:26	5:31
5:02	5:06	5:09	5:18	5:24	5:32	5:37	5:41	5:46
5:17	5:21	5:24	5:33	5:39	5:47	5:52	5:56	6:01
5:32	5:36	5:39	5:48	5:54	6:02	6:07	6:11	6:16
5:47	5:51	5:54	6:03	6:09	6:17	6:22	6:26	6:31
6:02	6:06	6:09	6:18	6:23	6:30	6:35	6:38	6:43
6:17	6:21	6:24	6:32	6:37	6:44	6:48	6:51	6:55
6:32	6:36	6:39	6:47	6:52	6:59	7:03	7:06	7:10
6:47	6:51	6:54	7:02	7:07	7:14	7:18	7:21	7:25
7:02	7:06	7:09	7:17	7:22	7:29	7:33	7:36	7:40
7:17	7:21	7:24	7:32	7:37	7:44	7:48	7:51	7:55
7:40	7:44	7:47	7:55	8:00	8:07	8:11	8:14	8:18
8:10	8:14	8:17	8:25	8:30	8:37	8:41	8:44	8:48
8:40	8:44	8:47	8:55	9:00	9:07	9:11	9:14	9:18
9:10	9:13	9:16	9:23	9:28	9:34	9:38	9:41	9:44
9:40	9:43	9:46	9:53	9:58	10:04	10:08	10:11	10:14
10:10	10:13	10:16	10:23	10:28	10:34	10:38	10:41	10:44
10:40	10:43	10:46	10:53	10:58	11:04	11:08	11:11	11:14
11:10	11:13	11:16	11:23	11:28	11:34	11:38	11:41	11:44
LIMITED STOP ZONE / ZONA DE PARADAS LIMITADAS								

Route 15 Saturday / sábado

Downtown → City Heights → SDSU

(I) Broadway & Front St. DEPART	(H) Broadway & 3rd Ave.	(G) City College Trolley	(F) Washington St. & Lincoln Ave.	(E) El Cajon Blvd. & 30th St.	(D) Boulevard Transit Plaza (@ Fwy. 15)	(C) El Cajon Blvd. & 54th St.	(B) College Ave. & El Cajon Blvd.	(A) SDSU Transit Center ARRIVE
5:02a	5:05a	5:09a	5:13a	5:18a	5:23a	5:30a	5:32a	5:37a
6:02	6:05	6:09	6:13	6:18	6:23	6:30	6:32	6:37
6:32	6:35	6:39	6:43	6:48	6:53	7:00	7:02	7:07
7:02	7:05	7:09	7:13	7:18	7:23	7:30	7:32	7:37
7:17	7:20	7:24	7:28	7:33	7:38	7:45	7:47	7:52
7:32	7:35	7:39	7:44	7:50	7:56	8:04	8:06	8:12
7:47	7:50	7:54	7:59	8:05	8:11	8:19	8:21	8:27
8:02	8:05	8:09	8:14	8:20	8:26	8:34	8:36	8:42
8:17	8:20	8:24	8:29	8:35	8:41	8:49	8:51	8:57
8:32	8:35	8:39	8:44	8:50	8:56	9:04	9:06	9:12
8:47	8:50	8:54	8:59	9:05	9:11	9:19	9:21	9:27
9:02	9:05	9:09	9:14	9:20	9:26	9:34	9:36	9:42
9:17	9:20	9:24	9:29	9:35	9:41	9:49	9:51	9:57
9:32	9:35	9:39	9:44	9:50	9:56	10:04	10:06	10:12
9:47	9:50	9:54	9:59	10:05	10:11	10:19	10:21	10:27
10:02	10:05	10:09	10:14	10:20	10:26	10:34	10:36	10:42
10:17	10:20	10:24	10:29	10:35	10:41	10:49	10:51	10:57
AND THEN EVERY 15 MINUTES AT: / Y LUEGO CADA 15 MINUTOS A LA:								
:32	:35	:40	:45	:52	:59	:08	:11	:17
:47	:50	:55	:00	:07	:14	:23	:26	:32
:02	:05	:10	:15	:22	:29	:38	:41	:47
:17	:20	:25	:30	:37	:44	:53	:56	:02
UNTIL: / HASTA:								
5:32p	5:35p	5:40p	5:45p	5:52p	5:59p	6:08p	6:11p	6:17p
5:47	5:50	5:55	6:00	6:07	6:14	6:23	6:26	6:32
6:02	6:05	6:10	6:15	6:21	6:27	6:35	6:37	6:42
6:17	6:20	6:25	6:30	6:36	6:42	6:50	6:52	6:57
6:32	6:35	6:40	6:45	6:51	6:57	7:05	7:07	7:12
6:47	6:50	6:55	7:00	7:06	7:12	7:20	7:22	7:27
7:02	7:05	7:10	7:15	7:21	7:27	7:35	7:37	7:42
7:17	7:20	7:25	7:30	7:36	7:42	7:50	7:52	7:57
7:42	7:45	7:50	7:55	8:01	8:07	8:15	8:17	8:22
8:13	8:15	8:19	8:23	8:29	8:34	8:41	8:43	8:48
8:43	8:45	8:49	8:53	8:59	9:04	9:11	9:13	9:18
9:13	9:15	9:19	9:23	9:29	9:34	9:41	9:43	9:48
9:43	9:45	9:49	9:53	9:59	10:04	10:11	10:13	10:18
10:13	10:15	10:19	10:23	10:29	10:34	10:41	10:43	10:48
10:43	10:45	10:49	10:53	10:59	11:04	11:11	11:13	11:18
11:13	11:15	11:19	11:23	11:29	11:34	11:41	11:43	11:48
11:43	11:45	11:49	11:53	11:59	12:04a	12:11a	12:13a	12:18a
12:13a	12:15a	12:19a	12:23a	12:29a	12:34	12:41	12:43	12:48
LIMITED STOP ZONE / ZONA DE PARADAS LIMITADAS								

SDSU → City Heights → Downtown