

AREMA PLAN DATA TABLE (28)

	CARRIER PIPE	CASING PIPE
CONTENTS TO BE HANDLED	POTABLE WATER	N/A
OUTSIDE DIAMETER	12.5"	24"
PIPE MATERIAL	STEEL	STEEL
SPECIFICATION AND GRADE	AWWA C200	ASTM A-283 GR C
WALL THICKNESS	3/4"	0.312"
ACTUAL WORKING PRESSURE	150 PSI	N/A
TYPE OF JOINT	FULL WELD	FULL WELD
COATING	NONE	EPOXY
METHOD OF INSTALLATION	INSERTION THROUGH CASING	JACK AND BORE
SEALS: BOTH ENDS: <input checked="" type="checkbox"/> ONE END: <input type="checkbox"/>	TYPE: FLEXIBLE COAL TAR WITH FIBERGLASS	
BURY: BASE OF RAIL TO TOP OF CASING	7 FT. 9 IN.	
BURY: (NOT BENEATH TRACKS)	4 FT. 0 IN.	
BURY: (ROADWAY DITCHES)	FT. IN.	
TYPE, SIZE AND SPACING OF INSULATORS OR SUPPORTS	SS CENTER RESTRAINED 11" LONG RUNNERS, 2 PER 10" OF PIPE EQUALLY SPACED	
DISTANCE C.L. TRACK TO FACE OF JACKING/RECEIVING PITS	50 FT. 0 IN. (MIN)	
BURY: BASE OF RAIL TO BOTTOM JACKING/RECEIVING PITS	9 FT. 4 IN. (MIN)	
CATHODIC PROTECTION? YES <input type="checkbox"/> NO <input checked="" type="checkbox"/>		

NOTE: SEE "PLAN REQUIREMENT GUIDELINES FOR MTS RIGHT OF ENTRY (ROE) PERMIT" ON MTS WEBSITE. BUBBLED NUMBERS ON THIS EXAMPLE PLAN CORRESPOND TO PLAN REQUIREMENTS.

- (1) MTS STANDARD CONSTRUCTION NOTES
- (25) MTS JACK AND BORE CONSTRUCTION NOTES
- (24) RR RELATIONS SPECIFICATIONS FOR SD&AE RELATIONS WITH MTS

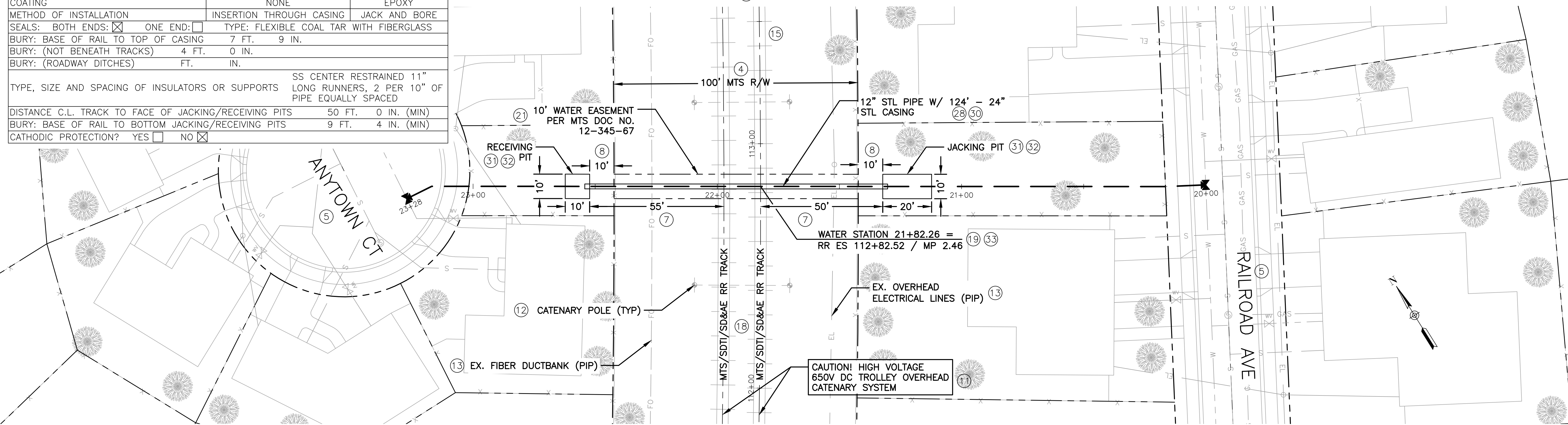
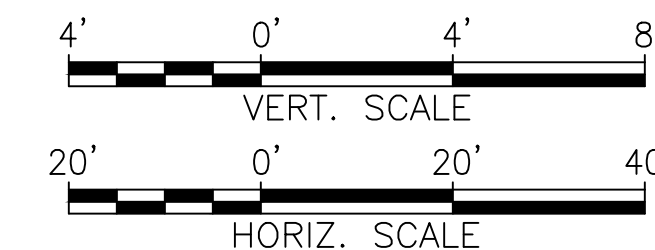

Z:\Engineering\MTS-Peopos_Contract\MTS-VIA355-AE-43_RIE_Plan_Reviews\900_CADD\950_Drawings\Example_&B\dwg\TMS-27-2026\19249

NO.	DATE	REVISIONS	BY	CHK	APRV

DESIGNED BY	DATE
XX	XX/XX
DRAWN BY	XX/XX
XX	XX/XX
CHECKED BY	XX/XX
XX	XX/XX
PRJ. ENG.	
X. XXXXXXXX	

SCALE	
AS NOTED	
CONTRACT NO.	
DRAWING NO.	SHEET NO.
	of 167

PLANS FOR THE CONSTRUCTION OF:
EXAMPLE PROJECT